

## Block Cavity Trays

AT Trays for abutments to blockwork are available in three sizes for different roof pitches and course heights. Manufactured from polypropylene. Intermediate Trays are handed. Catchment and Apex Trays are identical and suit all roof pitches from 25° to 55°. Trays also available for stonework.



CATCHMENT (Left & right)

## Typical Application

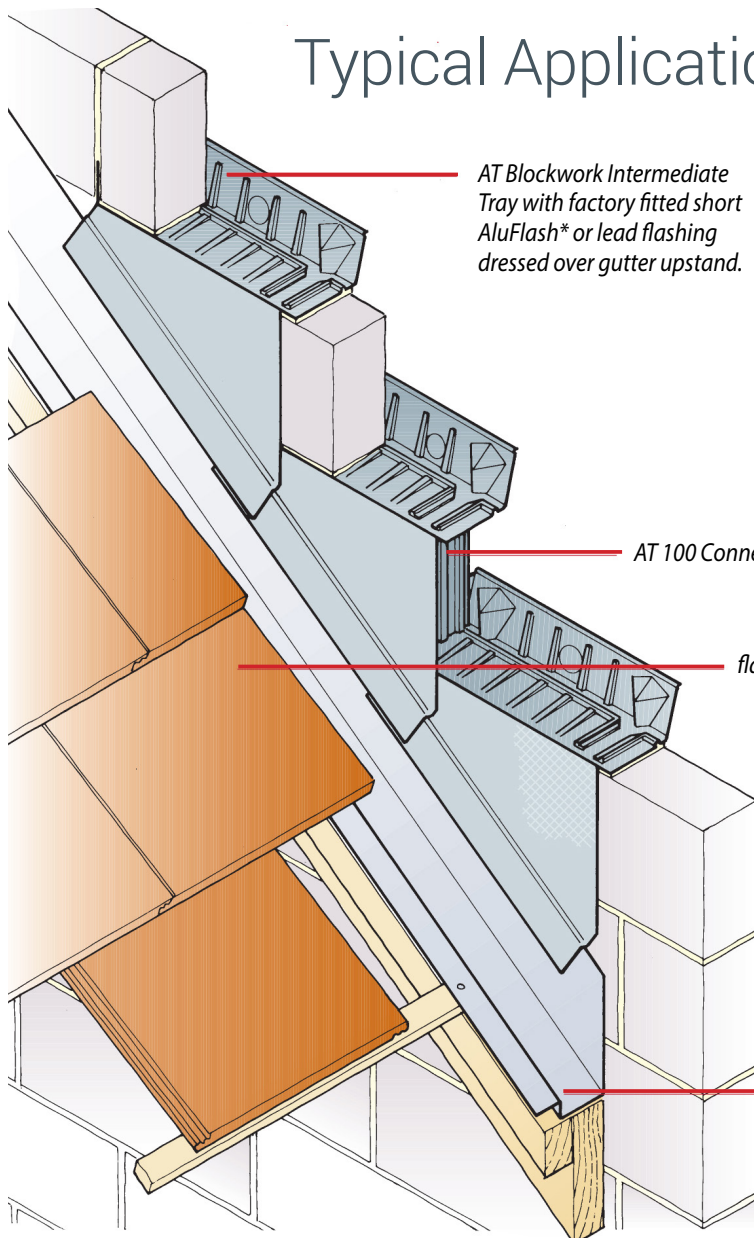

INTERMEDIATE (Left & right)

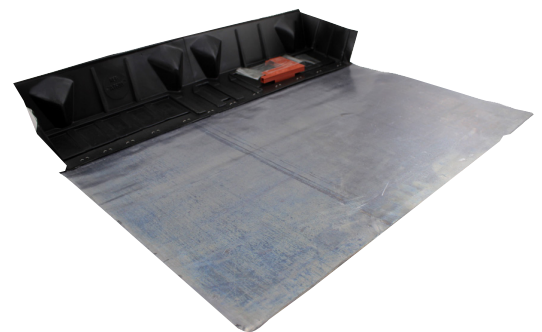

APEX

## Brick Cavity Trays

AT Abutment Trays offer preformed cavity tray solutions at the junction where the sloping edge of a pitched roof abuts a wall. The need for a tray at this point is not always fully appreciated; flashings and soakers are not sufficient. Below the roof line the external leaf of brick or blockwork becomes an internal wall, so it is necessary to prevent any moisture that penetrates the outer leaf from running down and into the building. NHBC Standards for 'External masonry walls' section 6.1-D6(a) and BS 8215: 1991 'Design and installation of damp proof courses in masonry construction' specifically recommend the use of preformed abutment cavity trays. Intra Weep AT Abutment Trays are manufactured from polypropylene and are available with optional factory-fitted AluFlash or lead flashings, avoiding the need to cut and dress flashings on site.

### Abutment with cavity tray

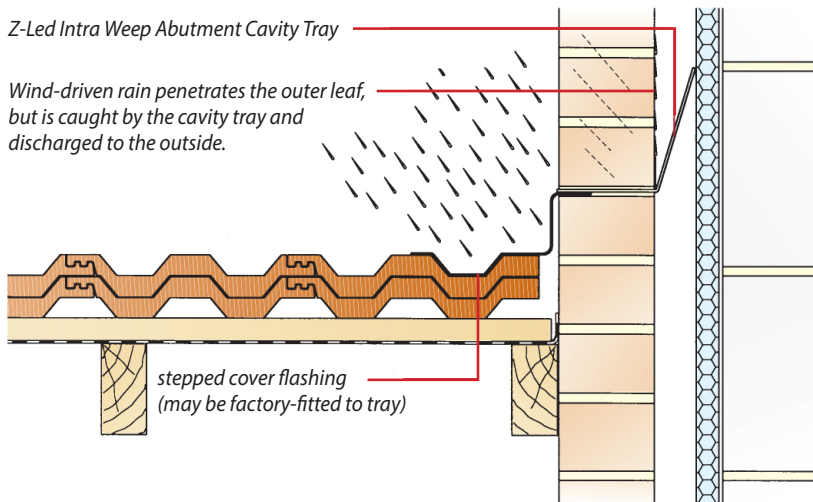

CATCHMENT (Left & right)

### Abutment without cavity tray

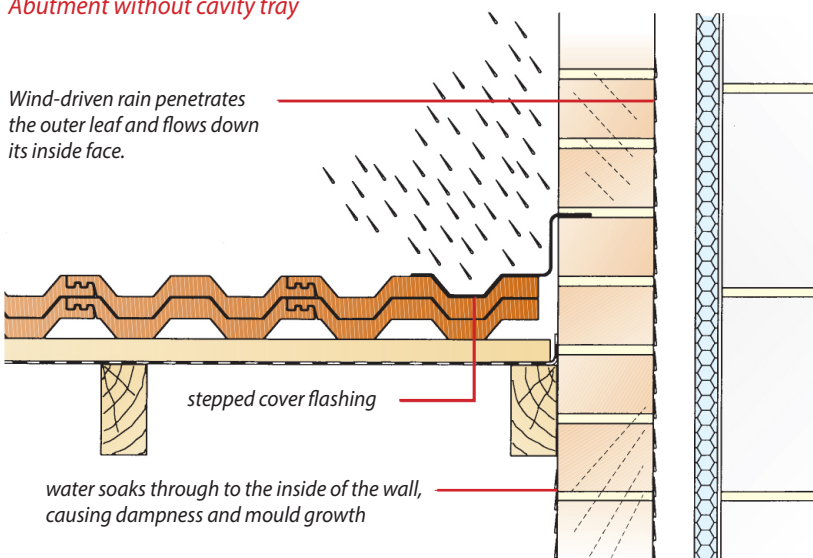

INTERMEDIATE (Left & right)



APEX

## Horizontal Cavity Trays

HT Trays are also available with factory fitted AluFlash\* or code 4 lead flashings to BS EN 12588: 2006, for use at the abutment of a lean-to or flat roof with a wall. HT trays fitted with AluFlash are supplied with 225mm flashings suitable for all applications. Long or short lead flashings are available to dress down over the roof covering in accordance with Lead Sheet Association recommendations as follows: - long flashings: roof pitches below 30° - short flashings: roof pitches of 30° and above. For flat roofs use the short flashing to cover the roof upstand by a minimum of 75mm. Where high-level ventilation is required, use HT Trays with short flashings and the MR50 Monovent.

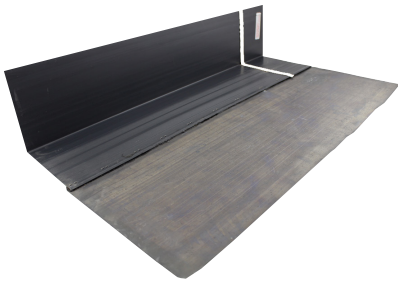

HORIZONTAL



EXTERNAL & INTERNAL CORNERS



END CAPS

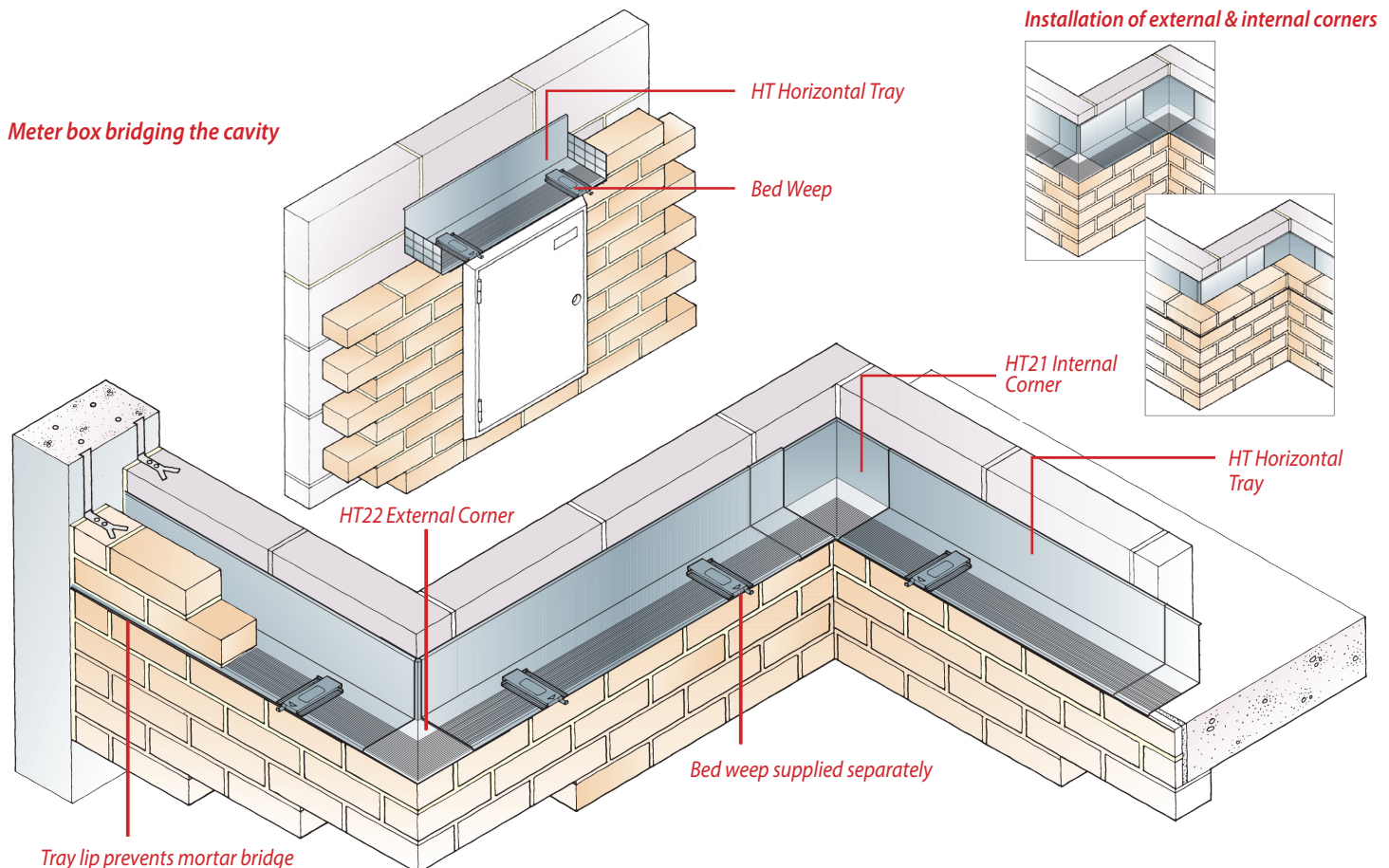



### BLOCKWORK Suits all slate & tile applications

#### CATCHMENT LEFT HAND

Code	Description	Pitch
ZAC602S25225	Catchment Left Hand	25°
ZAC602S30225	Catchment Left Hand	30°
ZAC602S35225	Catchment Left Hand	35°
ZAC602S40225	Catchment Left Hand	40°
ZAC602S45225	Catchment Left Hand	45°
ZAC602S50225	Catchment Left Hand	50°

#### CATCHMENT RIGHT HAND

ZAC601S25225	Catchment Right Hand	25°
ZAC601S30225	Catchment Right Hand	30°
ZAC601S35225	Catchment Right Hand	35°
ZAC601S40225	Catchment Right Hand	40°
ZAC601S45225	Catchment Right Hand	45°
ZAC601S50225	Catchment Right Hand	50°

#### INTERMEDIATE LEFT HAND

ZAT602S25225	Intermediate Left Hand	25°
ZAT602S30225	Intermediate Left Hand	30°
ZAT602S35225	Intermediate Left Hand	35°
ZAT602S40225	Intermediate Left Hand	40°
ZAT602S45225	Intermediate Left Hand	45°
ZAT602S50225	Intermediate Left Hand	50°

#### INTERMEDIATE RIGHT HAND

ZAT601S25225	Intermediate Right Hand	25°
ZAT601S30225	Intermediate Right Hand	30°
ZAT601S35225	Intermediate Right Hand	35°
ZAT601S40225	Intermediate Right Hand	40°
ZAT601S45225	Intermediate Right Hand	45°
ZAT601S50225	Intermediate Right Hand	50°

#### APEX TRAY SHORT LEAD

ZAT600S2535225	Apex Tray Short Lead	25° - 35°
ZAT600S4050225	Apex Tray Short Lead	40° - 50°

### BRICKWORK Suits all slate & tile applications

#### CATCHMENT LEFT HAND

Code	Description	Pitch
ZAC302S2575	Catchment Left Hand	25°
ZAC302S3075	Catchment Left Hand	30°
ZAC302S3575	Catchment Left Hand	35°
ZAC302S4075	Catchment Left Hand	40°
ZAC302S4575	Catchment Left Hand	45°
ZAC302S5075	Catchment Left Hand	50°

#### CATCHMENT RIGHT HAND

ZAC301S2575	Catchment Right Hand	25°
ZAC301S3075	Catchment Right Hand	30°
ZAC301S3575	Catchment Right Hand	35°
ZAC301S4075	Catchment Right Hand	40°
ZAC301S4575	Catchment Right Hand	45°
ZAC301S5075	Catchment Right Hand	50°

#### INTERMEDIATE LEFT HAND

ZAT302S2575	Intermediate Left Hand	25°
ZAT302S3075	Intermediate Left Hand	30°
ZAT302S3575	Intermediate Left Hand	35°
ZAT302S4075	Intermediate Left Hand	40°
ZAT302S4575	Intermediate Left Hand	45°
ZAT302S5075	Intermediate Left Hand	50°

#### INTERMEDIATE RIGHT HAND

ZAT301S2575	Intermediate Right Hand	25°
ZAT301S3075	Intermediate Right Hand	30°
ZAT301S3575	Intermediate Right Hand	35°
ZAT301S4075	Intermediate Right Hand	40°
ZAT301S4575	Intermediate Right Hand	45°
ZAT301S5075	Intermediate Right Hand	50°

#### APEX TRAY SHORT LEAD

ZAT300S253575	Apex Tray Short Lead	25° - 35°
ZAT300S405075	Apex Tray Short Lead	40° - 50°

#### HORIZONTAL TRAYS

ZHT5S	Horizontal Cavity Tray	1125mm
ZHT4S	Horizontal Cavity Tray	900mm
ZHT3S	Horizontal Cavity Tray	675mm

#### INTERNAL & EXTERNAL CORNERS

ZHT22S	Ext. Corner - Short Lead Flashing
ZHT21S	Int. Corner - Short Lead Flashing

#### END CAPS

ZHT11	End Cap Left
ZHT12	End Cap Right